

Duff-Norton

OPERATING & MAINTENANCE INSTRUCTIONS

WITH PARTS LISTS

PUBLICATION PART NO. CA-680-1

**COFFING®
HOIST**

CA ALUMINUM HAND CHAIN HOIST

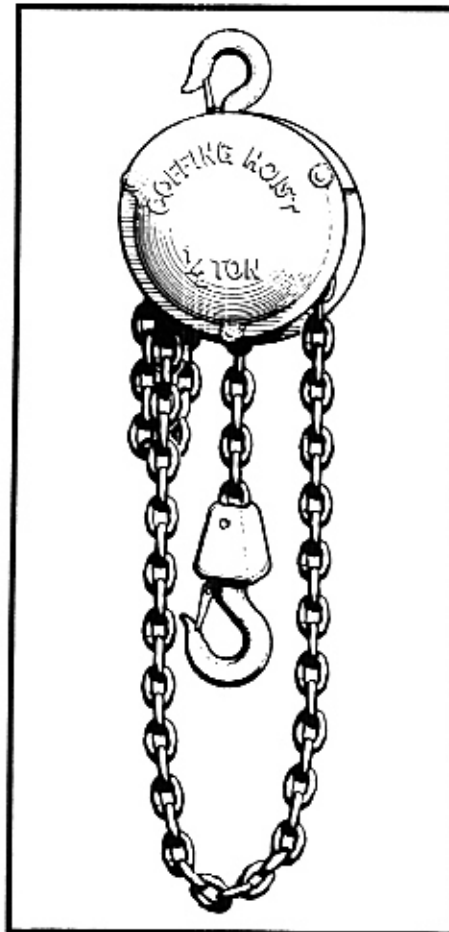

CA SERIES

IMPORTANT — CAUTION

This manual contains important information for the correct installation, operation and maintenance of the equipment described herein. All persons involved in such installation, operation, and maintenance should be thoroughly familiar with the contents. To safeguard against the possibility of personal injury or property damage, follow the recommendations and instructions of this manual and keep it for further reference.

WARNING

The equipment shown in this manual is intended for industrial use only and should not be used to lift, support, or otherwise transport people, or to suspend unattended loads over people.

BEATON

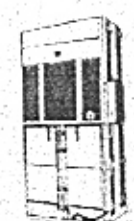

OVERHEAD EQUIPMENT HOISTS

ERGONOMICS

HYDRAULIC BALERS

AIR CURTAINS
BALERS/COMPACTORS
BELOW HOOK
BENCHES/CARTS/TOOLS
BRIDGE CRANES



CONVEYOR



BRIDGE CRANES



WRAPPERS

CABINETS
CASTERS/WHEELS
CONTAINERS/WHEELS
CONVEYORS
DOCK EQUIPMENT
ENGINEERED SYSTEMS
FLOOR MATTING
OVERHEAD DOORS
DRUM HANDLING
FLAMMABLE CABINETS



SLINGS

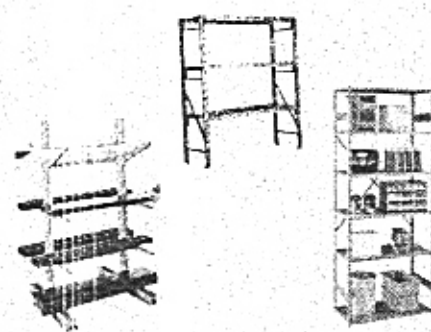

RACKING/SHELVES



SHOP EQUIPMENT

FLOW RACK
GANTRY CRANES
GUARD RAIL
HAND TRUCKS
HIGH SPEED ROLL UP DOORS
HOISTS



HAND TRUCKS

Beaton Industrial, Inc.

6083 Trenton Road
Utica, NY 13502

Ph. 1-800-724-4052 (N.Y. Only)

Ph. 1-315-797-9346

Fax 1-315-797-9321

e-mail:

beaton@deamscape.com

Web:

www.BeatonIndustrial.com

INDUSTRIAL BATTERIES
INDUSTRIAL VACUUMS
INPLANT OFFICES
INSTALLATIONS
JIB CRANES
LAYOUTS/DESIGNS
LIFTERS

LIFT TABLES
LOCKERS
MACHINE MOVERS
MESSAGE TRANSFER
MEZZANINES
MODULAR DRAWER CABINETS
MOBILE AISLE STORAGE
OFFICE FURNITURE
OVERHEAD LIFTING EQUIPMENT
PALLET TRUCKS
PERSONNEL LIFTS
SAFETY LADDERS
SCALES



PULLERS

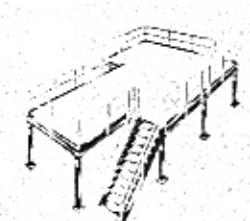

MEZZANINES

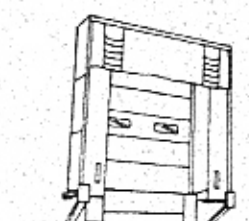

DOCKS, DOORS, SEALS

SELF DUMPING HOPPERS
SERVICE/SERVICE CONTRACTS
STACKER CRANES
STORAGE PRODUCTS
STRETCH WRAP MACHINES
SHIPPING SUPPLIES
TABLES
TOILET PARTITIONS
AND MANY MORE...

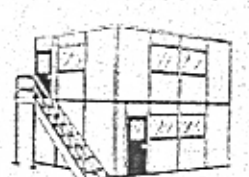

INPLANT OFFICES



CASTERS

HOIST AND CRANE REPAIR CENTER
INSTALLATIONS, PARTS, SERVICE
DESIGN/LAYOUT/ FABRICATIONS,
APPLICATION STUDIES
CRANE & HOIST INSPECTIONS

"Specializing In Materials Handling"

Coffing® and Little Mule® Authorized Warranty Repair Centers and Parts Depots

ALABAMA

- **Tool Smith Co.**
1300 4th Ave. South, Birmingham AL 35233
(205) 323-2576 (800) 317-8665 Fax (205) 323-9060

ARKANSAS

- **Hi-Speed Hoist & Crane**
710 N. Maple St. N. Little Rock AR 72114
(501) 375-9178 Fax (501) 375-4254
- **Handling Systems & Conveyers Inc.**
10909 East Otter Creek Rd. Mabelville AR 72103
(501) 455-5898 Fax (501) 455-6179

ARIZONA

- **Mechanics Tool Service**
1301 E. Apache Park Place, Tuscon AZ 85714
(520) 889-8484 AZ only (800) 372-6700 Fax (520) 889-6668

CALIFORNIA

- **Arrow Crane Hoist Corp.**
12714 South Carmenita Road, Santa Fe Springs CA 90670
(562) 921-8328 Fax (562) 921-9307
- **IDG Continental - McLaughlin**
7141 Paramont Blvd., Pico Rivera CA 90660 (Rick)
(562) 949-7881 Fax (562) 948-4448
- **Crane Works, Inc.**
2585 Nicholson Street, San Lomdro CA 94577
(510) 357-4000 Fax (510) 357-4099
- **Kimmerle Brothers, Inc.**
12060 East Florence Street, Santa Fe Springs CA 90670
(562) 946-6771 Fax (562) 944-3473
- **Kimmerle Brothers, Inc.**
226 11th Street, San Francisco CA 94103
(415) 431-1163 Fax (415) 431-1693
- **Kimmerle Brothers, Inc.**
337 "M" Street, Fresno CA 93721
(559) 233-1278 Fax (559) 233-4678

COLORADO

- **Crane Repair Co.**
3718 Norwood Drive, Littleton CO 80125
(303) 791-7918 (800) 878-7918 Fax (303) 791-7179

DELAWARE

- **Philidelphia Tramrail (Div. of Morris)**
137 Sandy Drive, Newark DE 19713
(302) 369-5819 (800) 346-2098 Fax (302) 369-5829

FLORIDA

- **J. Herbert Corp.**
1751 S. John Young Parkway, Kissimmee FL 32741
(407) 846-0588 (800) 255-0588 Fax (407) 846-1066
- **Material Handling Systems**
720 S.W. 4th Court, Dania FL 33004
(954) 921-1171 (888) 424-6478 Fax (945) 921-7117

GEORGIA

- **Ace Industries, Inc.**
6295 McDonough Drive, Norcross GA 30093
(770) 441-0898 (800) 733-2231 Fax (800) 628-3648

ILLINOIS

- **Industrial Tool Products**
919 N. Central Avenue, Woodale IL 60191
(830) 766-4040 (800) 525-9654 Fax (630) 766-4166

- **Sievert Electric Service KSIE130 (Larry)**
1230 South Hannah, Forest Park IL 60130
(708) 771-1600 (800) 322-9144 Fax (708) 771-3124

INDIANA

- **Brehob Corp.**
1334 S. Meridian Street, Indianapolis IN 46225
(317) 231-8080 (800) 632-4451 Fax (317) 231-8072
- **Materials Handling Equipment**
7433 U.S. 30 East, Fort Wayne IN 46803
(219) 749-0475 (800) 443-6432 Fax (219) 749-0481

IOWA

- **Alter & Sons, Inc.**
514 S. Howell Street, Davenport IA 52808
(319) 323-3601 (800) 553-1111 Fax (319) 324-0138

KENTUCKY

- **Advanced Sherman**
330 North Spring St., Louisville KY 40206
(502) 896-2166 (800) 633-8186 Fax (502) 897-9837
(Kentucky only)

LOUISIANA

- **Rental Service**
3301 Cities Service Hwy., West Lake LA 70669
(318) 882-6011 Fax (318) 882-0325
- **Drillco**
12649 S. Chactaw Drive, Baton Rouge LA 70815
(504) 272-8251 (800) 851-3821 Fax (800) 315-9225

MICHIGAN

- **Continental Crane & Service Co.**
33681 Groesbeck Hwy., Fraser MI 48026
(810) 293-3870 Fax (810) 293-0017

MINNESOTA

- **Electric Motor Repair, Inc.**
2010 N. 4th Street, Minneapolis MN 55411
(612) 522-3318 (800) 345-0198 Fax (612) 588-1617
- **J & B Equipment Co. Inc.**
8200 Grand Ave. South, Bloomington MN 55420
(612) 884-2040 Fax (612) 346-1139

MISSOURI

- **Total Tool Supply**
315 N. Pierce Street, St. Paul MN 55104
(612) 646-4055 (800) 444-4899 Fax (612) 646-8610
- **Contractors Supply Co.**
800 E. 18th Street, Kansas City MO 64108
(816) 221-7788 (800) 669-7788 Fax (816) 221-0817

- **Zeller Electric KZEL125 (Dave, Sandy)**
(29985) 4250 Hoffmeister, St. Louis MO 63125
(314) 638-9641 Outside MO(800) 530-581 Fax (314) 638-6318

MONTANA

- **Industrial Tool & Repair**
2123 2nd Ave. North Billings Montana 59101
(406) 252-8114 (800) 823-8665 Fax (406) 259-3956

NEW JERSEY

- **Sissco**
186 Route 206 South, Sommerville NJ 08876
(908) 359-9767 (800) 892 0146 Fax (908) 359 9773

Coffing® and Little Mule® Authorized Warranty Repair Centers and Parts Depots Cont'd.

NEW YORK

- **ABC Electric**
24-25 46th Street, Long Island City, NY 11103
(718) 956-0000 (800) 562-1919 Fax (718) 956-4455
(New York only)
- **Beaton Industrial, Inc.**
6083 Trenton Rd., Utica NY 13502 (Rob, Jeff)
(315) 797-9346 (800) 724-4052 Fax (315) 797-932
- **Volland Electric Equipment Co.**
75 Innsbruck Drive, Buffalo NY 14227 (Brad)
(716) 656-9900 Fax (716) 656-8899

NORTH CAROLINA

- **Carolina Hoist**
3310 E. Wendover Avenue, Greensboro NC 27405
(336) 375-6050 (800) 326-3655 Fax (336) 375-6053
- **Southern Electric Service**
2225 Freedom Drive, Charlotte NC 28266 (Dave)
(704) 372-4832 (800) 487-3726 Fax (704) 342-2604

OHIO

- **Crane America-H. W. House**
920 Deneen Ave., Monroe OH 45050 (Bob, Dave, Mary)
(513) 539-9770 (800) 331-5326 Fax (513) 539-9577
- **Americrane & Hoist Corp.**
13224 Enterprise Ave., Cleveland OH 44135
(216) 267-9100 (800) 652-1932 Fax (216) 267-9131

OKLAHOMA

- **Gaffey, Inc.**
6951 E. 12th Street, Tulsa OK 74112
(918) 836-6827 (800) 331-3916 Fax (918) 835-6138

OREGON

- **General Tool & Supply Co.**
2705 N.W. Nicolai, Portland OR 97210
(503) 226-3411 (800) 783-3411 Fax (503) 778-5518

PENNSYLVANIA

- **Globe Electric Co.**
200 23rd Street, Pittsburgh PA 15215
(412) 781-2677 (800) 850-4440 Fax (412) 781-1812
- **McDal Corp.**
475 East Church Rd., King of Prussia PA 19406
(610) 277-5484 (800) 626-2325 Fax (610) 277-4690
- **Repair Unlimited**
1730 Rockwell Road, Abington PA 19001
(215) 657-3335 (800) 369-5891 Fax (215) 784-0343

RHODE ISLAND

- **Motors, Hoist, & Controls Inc.**
179 Railroad Street, Woonsocket RI 02895
(401) 767-4568 Fax (401) 767-4567

SOUTH CAROLINA

- **Engineered Systems, Inc.**
125 Sunbelt Court, Greer SC 29650 (Greg)
(864) 879-7438 (800) 879-7438 Fax (864) 848-3143

TENNESSEE

- **Hoist & Crane Co.**
1106 Elm Hill Pike, Nashville TN 37210
(615) 242-3383 Fax (615) 255-4379
- **Hi-Speed Electrical Co.**
3013 Thomas Street, Memphis, TN 38127
(901) 357-6231 Fax (901) 357-6238

TEXAS

- **Abel Equipment Co., Inc.**
3710 Cavalier Drive, Garland TX 75042
(972) 272-7706 Fax (800) 272-2235
- **Gaffey, Inc.**
4301 Garland Drive, Ft. Worth TX 76117 (Jessica)
(817) 281-1994 (800) 284-4233 Fax (817) 581-7831
- **Gaffey, Inc.**
4003 S. County Rd. 1297, Odessa TX 79765
(915) 563-2897 (800) 733-0006 Fax (915) 563-4703
- **Gaffey, Inc.**
1436 N. Duck Creek Rd., Cleveland TX 77327
(281) 443-6690 (800) 233-8179 Fax (281) 592-6984
- **Hydraulic Equipment Ser.**
1021 N. San Jacinto Street, Houston TX 77002 (Tony)
(713) 228-4073 Fax (713) 228-0931

UTAH

- **Rocky Mountain Wire Rope & Rig.**
2421 South 2570 West, Salt Lake City UT 84119
(801) 972-4972 (800) 615-3193 Fax (801) 974-0621

VIRGINIA (Richmond Area)

- **Foley Material Handling Co.**
11327 Va. Crane Drive, Ashland VA 23005
(804) 798-1343 Fax (804) 798-7843

WASHINGTON

- **B & J Industrial Supply Co.**
5601 1st Avenue South, Seattle WA 98108
(206) 762-4430 (800) 767-4430 Fax (206) 762-5329

WISCONSIN

- **Alferi Industrial Sales & Service**
346 Smith Street, Neenah WI 54956 (Dewey, Bill)
(920) 722-6483 Fax (920) 722-6489

U.S. TERRITORIES (Puerto Rico)

- **Musique Express**
State Rd. 174 Block 11 No. 16, Santa Rosa Bayamen PR 00959
(787) 787-2306 Fax (787) 785-4882



P.O. Box 779 • Wadesboro, NC 28170
Parts Service: Phone 1-800-477-5004
FAX 1-800-374-6853

TABLE OF CONTENTS

| | | |
|-------------|---|---|
| SECTION I | INTRODUCTION | 1 |
| 1-1 | General Information | 1 |
| 1-4 | Hoist Construction | 1 |
| 1-6 | Leading Particulars | 1 |
| SECTION II | PREPARATION FOR USE | 1 |
| 2-1 | Inspection Prior to Initial Use | 1 |
| 2-4 | Installation | 1 |
| 2-6 | Testing | 1 |
| SECTION III | OPERATION | 2 |
| 3-1 | Safety Considerations | 2 |
| 3-3 | Operation | 2 |
| SECTION IV | MAINTENANCE | 3 |
| 4-1 | Inspections | 3 |
| 4-3 | Frequent Inspections | 3 |
| 4-5 | Periodic Inspections | 3 |
| 4-7 | Inspection of Hoists Not in Regular Use | 4 |
| 4-9 | Checking Chain for Wear | 4 |
| 4-11 | Lubrication | 4 |
| 4-13 | Disassembly | 5 |
| 4-15 | Cleaning | 5 |
| 4-17 | Assembly | 5 |
| SECTION V | ILLUSTRATED PARTS LIST | 8 |
| 5-1 | General | 8 |

WARRANTY

Every hoist is thoroughly inspected and tested prior to shipment from the factory. Should any problems develop, return the complete hoist prepaid to your nearest Duff-Norton Authorized Warranty Repair Station. If inspection reveals that the problem is caused by defective workmanship or material, repairs will be made without charge and the hoist will be returned, transportation prepaid.

This warranty does not apply where: (1) deterioration is caused by normal wear, abuse, improper or inadequate power supply, eccentric or side loading, overloading, chemical or abrasive actions, improper maintenance or excessive heat; (2) problems resulted from repairs,

modifications or alterations made by persons other than factory or Duff-Norton Authorized Warranty Repair Station personnel; (3) the hoist has been abused or damaged as a result of an accident; (4) repair parts or accessories other than those supplied by Duff-Norton Company are used on the hoist. Equipment and accessories not of the seller's manufacture are warranted only to the extent that they are warranted by the manufacturer. EXCEPT AS STATED HEREIN, DUFF-NORTON COMPANY MAKES NO OTHER WARRANTIES, EXPRESS OR IMPLIED, INCLUDING WARRANTIES OF MERCHANTABILITY AND FITNESS FOR A PARTICULAR PURPOSE.

SECTION I INTRODUCTION

1-1. GENERAL INFORMATION.

1-2. This manual provides necessary and proper information for persons engaged in the operation and maintenance of this Coffing CA Hand Chain Hoist. All persons operating or maintaining this hoist must be familiar with the information contained herein. Adherence to the precautions, procedures and maintenance practices described herein should ensure long and satisfactory use of your hoist with minimum danger to life, limb and property. The information contained herein applies to hoists used in normal service conditions. If any operating or maintenance information herein seems inadequate for your particular application please call or write our service engineers. We solicit your suggestions for improvements to this manual.

1-3. All persons concerned with the installation, operation, inspection and maintenance of this hoist are urged to read American National Standard ANSI B30.16. That standard contains important rules (some mandatory and some of an advisory nature) designed primarily to prevent or minimize injury and otherwise protect life, limb and property. You should especially be aware of the mandatory rules pertaining to inspection requirements and the advisability of maintaining written, dated and signed inspection reports and records.

1-4. HOIST CONSTRUCTION.

1-5. This Coffing Hoist has a strong, lightweight aluminum housing for portability. Gearing is made from alloy steel forgings. Hooks are steel forgings and the load chain is heat-treated alloy steel. The hand chain wheel is one piece construction of aluminum alloy.

1-6. LEADING PARTICULARS.

1-7. The operator should be aware of the capabilities of his hoist. He must refrain from overloading. Overloading not only can cause damage to the hoist, but presents serious threats to persons around the hoist. See Table I for some leading particulars with which the operator should be familiar.

TABLE I. LEADING PARTICULARS.

| | |
|---|----------------|
| Capacity | 1000 Pounds |
| Weight With Standard Chain | 22 Pounds |
| Standard Lift | 8 Feet |
| Pull on Hand Chain To Raise | |
| Load (Approx.) | 58 Pounds |
| Pull on Hand Chain To Lower | |
| Load (Approx.) | 7 Pounds |
| Hand Chain Overhaul for One | |
| Foot Lift | 18 Feet |
| Throat Opening of Standard Hook | 1 Inch |
| Maximum Distance Between Hooks | 110-5/8 Inches |
| Minimum Distance Between Hooks | 13-1/4 Inches |

SECTION II PREPARATION FOR USE

2-1. INSPECTION PRIOR TO INITIAL USE.

2-2. Any new or repaired hoist, as well as the working area, shall be carefully inspected prior to initial installation and use. The inspection shall be made by or under the direction of a person familiar with hoist operations and industrial safety standards.

2-3. The following inspection criteria are recommended prior to initial installation and use. Additional inspection items should be added to satisfy local usage and safety requirements. All inspections of any kind should be logged or recorded, dated, signed and filed for reference purposes.

a. Ensure that the supporting structures are strong enough to carry the intended loads. The supporting structure shall have a safe load rating at least equal to that of the hoist. The supporting structure must be rigid and not subject to weakening due to repeated stresses from the hoist.

b. Ensure that there is adequate working space to permit hoist operation in the hanging position only. Normal operation should not require pulling or tugging around corners or obstructions. Also, there must be adequate space to permit the operator to stand clear of the load and adjacent structures.

c. Watch out for makeshift or compromising prac-

tices either during installation or subsequent operation of the hoist. Sometimes the "temporary" fix remains until an accident occurs.

d. Perform both the frequent and the periodic inspections specified herein on a repaired hoist prior to initial use. Perform the frequent inspections specified herein on a new hoist prior to initial use.

2-4. INSTALLATION.

2-5. Secure the hoist to a suitable supporting member by use of the top hook. Make sure that the hook latch is closed. Apply a small amount of lubricate or equivalent between the hook and supporting member.

2-6. TESTING.

2-7. Check the hoist through a few lifting and lowering cycles with no load on the hook. Attach a load of fifty pounds to the hook and check the hoist through a few lifting and lowering cycles. Check for hook drift. The hook shall not drift more than one inch. If brake operation is normal with this light load, test the hoist for operation with rated load (1000 pounds), and then with 125 percent of rated load (1250 pounds). The hoist shall operate smoothly and the brake shall prevent hook drift in excess of one inch at both rated load and 125 percent of rated load.

SECTION III OPERATION

3-1. SAFETY CONSIDERATIONS.

3-2. This hoist is designed for proper operation within the limits of its rated capacity. The hoist has features designed to minimize the potential for injury due to the failure of the hoist itself. However, here are some additional pointers which should be followed in order to ensure proper operation.

- a. Do not overload the hoist.
- b. Avoid side loading. Always pull in a straight line between hooks. Side loading over a sharp corner may fracture the hoist housing.
- c. Be sure there are no twists in the load chain.
- d. Before raising a load, always check to see that it is held securely in the hook or sling chains, etc. Raise the load only until the load chain is taut and then recheck the rigging before continuing to raise the load.
- e. Make sure that the slings and other rigging have sufficient capacity to support the load, are in good condition and securely attached to hoist and load.
- f. **DO NOT STAND BENEATH A LOAD!** Do not move a load in such a manner as to endanger personnel.
- g. Never leave a suspended load unattended.
- h. Do not wrap the load chain around a load, **USE A SLING!**
- i. Do not **TIP-LOAD** any hook, as this will exert undue strain in the hook, resulting in hook failure.
- j. The CA Hand Chain Hoist is designed for manual operation. Do not operate hoist with other than manual power.
- k. **DO NOT USE HOIST TO LIFT, SUPPORT OR OTHERWISE TRANSPORT HUMAN CARGO.**

3-3. OPERATION.

3-4. The hoist should be operated by qualified personnel only. The operator shall familiarize himself with the hoist and its proper care. If adjustments or repairs are necessary or any damages known or suspected, he shall report the same promptly to the person authorized to correct the problem. He shall also notify the next operator of the damages upon changing shifts. If an "Out-of-Order" tag is on the hoist, the operator shall not start operation until the tag has been removed by an authorized person. The operator should not engage in any practice which will divert his attention while operating the hoist.

3-5. **ATTACHING THE LOAD.** Attach the load to the hook by means of slings or other approved devices. Make sure the slings or other devices are seated properly in the saddle of the hook before lifting. Be sure the hook latch is closed and working properly. Never wrap the load chain around the load.

3-6. **LIFTING THE LOAD.** To raise the load, pull hand chain downward in a clockwise direction while facing the hand chain wheel housing. To lower the load, pull hand downward in a counterclockwise direc-

tion while facing the hand chain wheel housing. See figure 3-1. Lift the load as follows.

- a. Before lifting, make sure the hand chain is properly seated in the hand chain wheel.
- b. Lift the load a few inches and check to see that it is well balanced in the sling or other lifting device. Make sure the load chain is not kinked or twisted or that the load does not contact any obstruction.
- c. Test the brakes each time a load approaching the rated load (1000 pounds) is handled by raising the load just enough to clear the floor, or supports, and checking for brake action.
- d. Lift the load to the desired height. Do not leave the load suspended in the air for extended or unattended periods.

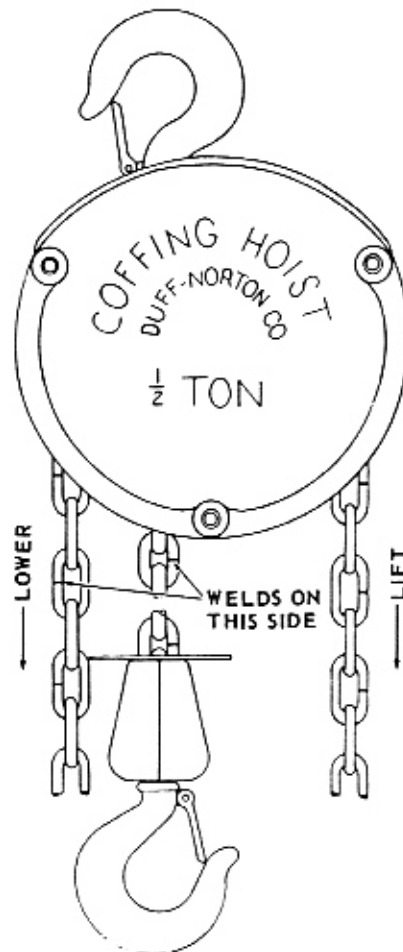

FIGURE 3-1. HAND CHAIN DIRECTION.

SECTION IV MAINTENANCE

4-1. INSPECTIONS.

4-2. A planned inspection routine should be established for this hoist based upon frequency of use, severity of use, and environmental conditions. (Reference American National Standard ANSI B30.16) Some inspections should be made frequently (daily to monthly) and others periodically (monthly to yearly). It is strongly recommended that an Inspection and Maintenance Check List and an Inspector's Report similar to those shown in figures 4-7 and 4-6 be used and filed for reference. All inspections should be made by, or under the direction of a designated inspector. Special inspections should be made following any significant repairs or any operating occurrence leading one to suspect that the hoist's capabilities may have been impaired. Refer to paragraphs 4-13 and 4-17 for assistance in any disassembly and assembly necessary for inspections and subsequent replacement or repair. Prior to inspection, clean parts as required. See paragraph 4-15.

4-3. FREQUENT INSPECTIONS.

4-4. Perform the following inspections daily prior to initial use of the hoist. Also, observe during operation for any damage which might appear between regular inspections.

CAUTION: Any unsafe condition disclosed by the inspection shall be corrected before operation of the hoist is resumed. Adjustments and repairs shall be done only by designated personnel.

a. Inspect the hooks for deformations, chemical damage or cracks. Hooks damaged from chemicals, deformation or cracks, or having throat openings greater than 1.15 inch must be replaced. See figure 4-1. If the hook is twisted more than 10 degrees from the unbent hook, it must be replaced.

NOTE: Any hook that is twisted or has throat openings in excess of 1.15 inch indicates abuse or overloading of the hoist. Other load bearing components should be inspected accordingly.

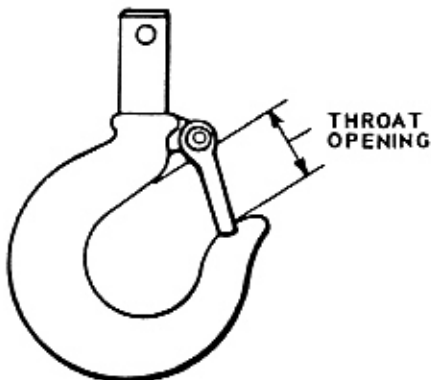

FIGURE 4-1. HOOK THROAT OPENING.

b. Check that both hooks swivel freely.

c. Check the brakes for slippage under load. When properly operating, the braking mechanism will automatically stop and hold up to 125 percent of hoist capacity when the hand chain is released.

d. Check load chain for wear, twist and distortion and ensure that dead end connection is secure. Also check for presence of foreign material and adequate lubrication.

4-5. PERIODIC INSPECTIONS.

4-6. It is recommended that the following inspections be performed at one to 12 month intervals. The exact period of inspection will depend on frequency and type of usage. Determination of this period will be based on the user's experience. It is recommended that the user begin with a monthly inspection and extend the periods to quarterly, semi-annually or annually based on his monthly experience.

CAUTION: Any unsafe condition disclosed by the inspection shall be corrected before operation of the hoist is resumed. Adjustments and repairs shall be done only by designated personnel.

a. Perform all the frequent inspections listed in paragraph 4-4.

b. Check nuts, bolts and other hardware for looseness, stripped or damaged threads.

c. Check load sheave, hand chain wheel and chain attachments for distortion, cracks and excessive wear.

d. Check brake discs for excessive wear, glazing and oil contamination. Replace discs worn to a thickness of 5/64 inch or less.

e. Check pawl for excessive wear, binding and worn bearing.

f. Check pawl spring for breaks, corrosion and stretch.

g. Check load flange for excessive wear and scoring.

h. Check pawl stud for excessive wear and pawl retention.

i. Inspect gear and pinion shaft for inadequate lubrication, cracks, distortion, worn or broken teeth and damaged threads.

j. Inspect bearings for inadequate lubrication, distortion, binding and excessive wear.

k. Check housing, covers and swivel frames for cracks, distortion and damaged threads.

l. Inspect supporting structure and trolley (if used) for continued ability to support imposed loads.

m. Inspect warning label for legibility.

n. Inspect the load chain for gouges, nicks, weld splatter, corrosion and distorted links. Slacken the chain and inspect for wear at contact points. If wear is observed, or if stretching is suspected, measure the chain per paragraph 4-10. If any portion of the chain

is worn, nicked, twisted or stretched, replace the whole chain.

CAUTION: Do not attempt to reweld sections of the chain and do not try to add on to the chain. Use only chain supplied by our company; it is specially manufactured to very close tolerances of dimension, composition and heat treatment. A substitute chain may damage the load sheave. Never use "missing links" because they will jam in the load sheave.

d. Check hooks for cracks using dye penetrant, magnetic particle or other suitable detection method.

4-7. INSPECTION OF HOISTS NOT IN REGULAR USE.

4-8. If the hoist has been idle for one month or more, perform the inspections listed in paragraph 4-4. If the hoist has been idle more than six months, perform the inspections listed in paragraph 4-6.

4-9. CHECKING CHAIN FOR WEAR.

4-10. Chain inspection and evaluation is a very important phase of hoist maintenance. In general, removal of the load chain from the hoist is not necessary. To check the load chain for excessive wear, proceed as follows:

a. Inspect the chain for "elongation", which is a condition caused by overloading or wear. Table II shows the normal and reject lengths for CA hoist chain. A chain gauge similar to that shown in figure 4-2 or a Vernier caliper may be used. Hang the chain up or stretch it out on a work table in a taut position. Place one edge of the gauge or caliper over the end of a chain link. The number of links within the gauge limits will correspond to the "Number of Links" as indicated in Table II. If the last link, which should be within the gauge limits, makes contact or extends past the inside edge of the gauge, or if the reading of the Vernier caliper is equal to or greater than the "Reject

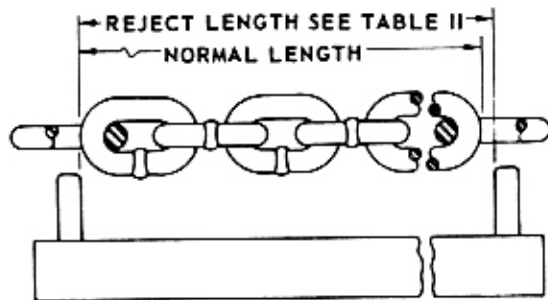

FIGURE 4-2. CHAIN SALVAGE GAUGE.

Length", the entire chain shall be replaced. If the last link does not contact the edge of the gauge, or the Vernier caliper reading is less than the "Reject Length", check the chain along its entire length. If all readings are within tolerance, the chain shall be free of elongation.

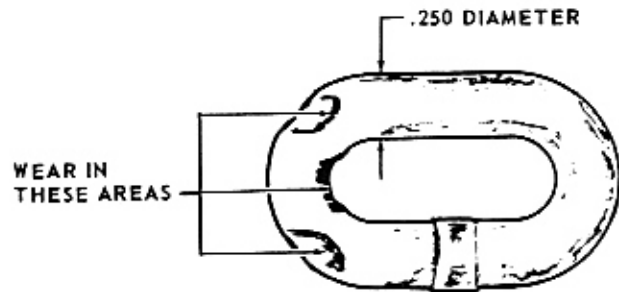

FIGURE 4-3. TYPICAL WEAR ON LINKS.

b. Inspect each individual chain link for wear to diameter of the link. See figure 4-3. The nominal diameter of the link is .250 inch. If the diameter of any link in the entire chain is below .200 inch, replace the entire chain.

4-11. LUBRICATION.

4-12. Proper lubrication is necessary for a long and relatively trouble-free hoist operation. Refer to the following and to Figure 4-6, Recommended Lubrication Schedule, for lubrication points, type of lubricant and frequency of lubrication.

a. **LOAD CHAIN.** Clean the load chain with acid-free solvent and coat with Coffing Chain Lubricant No. H-7595, or equivalent. Allow oil to work into each link end and be carried into the sheave pockets. Wipe excess oil to prevent dripping.

b. **GEAR AND PINION SHAFT.** After each periodic inspection during reassembly coat teeth of gear and pinion shaft with Coffing Lubricant No. H-7577, or equivalent.

c. **PINION SHAFT ROLLER BEARING.** After each periodic inspection during reassembly coat rollers with Coffing Lubricant No. H-7577, or equivalent.

d. **SHEAVE BEARINGS.** After each periodic inspection coat balls with a light coat of Coffing Lubricant No. H-7577, or equivalent.

TABLE II. LOAD CHAIN LENGTH.

| CAPACITY (TONS) | CHAIN PART NO. | NOM. DIA. | NO. OF LINKS | NORMAL LGTH FOR NO. LINKS | REJECT LGTH FOR NO. LINKS | GAUGE NUMBER |
|-----------------|----------------|-----------|--------------|---------------------------|---------------------------|--------------|
| 1/2 | C-19-8 | .250 | 19 | 14.766 | 14.957 | GA-3441 |

e. **BOTTOM HOOK BEARING.** Allow a few drops of SAE 20-30 oil to run down the hook shank and into the swivel.

f. **TOP HOOK THRUST WASHER.** Allow a few drops of SAE 20-30 oil to run down between the housing and hook shank.

4-13. **DISASSEMBLY.**

4-14. Disassemble the hoist as follows while referencing figure 5-1.

a. Remove dead end screw (36) and washers (2 and 37). While holding the free end of load chain (25) to assist in alignment of chain with load sheave, work chain through the hoist by pulling hand chain in the lowering direction.

b. Remove screw (27) and lock washer (28) and separate swivel frames (29 and 30). Remove warning label (26) from load chain (25). Press drive-lok pin (32) from hook collar (31) and remove hook collar and bearing (33) from bottom hook (34). Do not remove latch (35) from bottom hook unless replacement is required.

c. Remove three screws (1) and lock washers (2). Remove chain wheel cover (3).

d. Remove retaining ring (5) and thread stop (6), from pinion shaft (43).

e. Remove hand chain wheel (7) by turning wheel counterclockwise. Remove hand chain (8) from wheel. Remove roll pin (4) from wheel.

f. Remove front brake disc (9), bearing (10), brake ratchet (11), rear brake disc (12), load flange (13) and pin key (16) from pinion shaft (43). Do not remove bearing from brake ratchet.

g. Remove retaining ring (18) and pawl (19) from pawl stud (21). Remove pawl spring (17) from pawl. Do not remove spring anchor pin (20) from pawl.

h. Unscrew pawl stud (21) and remove pawl stud and lockwasher (22) from housing (39).

i. Remove two screws (45) and lock washers (2) and remove gear cover (44).

j. Remove retaining ring (46) and gear (47). Remove pinion shaft (43), and washer (42).

k. Remove retaining ring (24) from load sheave (48). Remove two sheave bearings (23), load sheave and chain wear strip (38) from housing (39).

l. Remove roll pin (49), nut (50), washer (51), and top hook (40) from housing (39). Do not remove latch (35) from hook unless replacement is required.

m. Remove roll pin (15) from housing (39). If necessary for inspection press bearings (14 and 41) from housing.

4-15. **CLEANING.**

4-16. All parts, except brake discs (9 and 12, figure 5-1), and bearings (10 and 14), may be cleaned by immersing in an acid-free solvent and dried with compressed air or a clean, lintless cloth. Wipe brake discs (9 and 12) and bearings (10 and 14) with a clean cloth dampened with solvent. Stubborn deposits of

dirt and grease may be removed from gears, housings, chains, etc., by using a stiff-bristled brush dipped in an acid-free solvent.

CAUTION: Ensure that adequate ventilation is provided when using cleaning solutions. Wear protective clothing, and avoid prolonged contact with solvents.

4-17. **ASSEMBLY.**

4-18. Assemble the hoist as follows while referencing figure 5-1.

a. If bearings (14 and 41) were removed for inspection, press bearings into housing (39) until outer edges of bearings are flush with housing. Apply a light coat of Cofing No. H-7579 grease, or equivalent, to rollers of bearing (41). Press roll pin (15) into housing if it has been removed.

b. Assemble top hook (40), nut (50) and washer (51) in housing (39). Screw nut on hook until approximately 1/64 inch vertical play (to allow hook to swivel freely) remains. Align pin hole in hook and slot in nut and insert roll pin (49).

c. Place wear strip (38) in housing (39). Apply a light coat of Cofing No. H-7577 grease, or equivalent to balls of sheave bearings (23). Insert load sheave (48) in housing and install sheave bearings. Install retaining ring (24) on load sheave.

d. Install washer (42) on pinion shaft (43) and insert pinion shaft in housing (39). Place gear (47) on load sheave (48) and install retaining ring (46).

e. Attach gear cover (44) to housing (39) with two lock washers (2) and screws (45).

f. Apply Cofing No. H-7502 Loctite, or equivalent, to threads of pawl stud (21) and install lock washer (22) and pawl stud.

g. Attach pawl spring (17) to pawl and place pawl on pawl stud (21). Install retaining ring (18). Place the loose end of reverse ring spring on roll pin (15).

h. Place pin key (16) in hole in pinion shaft (43). Install load flange (13), rear brake disc (12) (asbestos material), brake ratchet, and front brake disc (9) (metal) on pinion shaft.

i. Press roll pin (4) in hand chain wheel (7). Place hand chain (8) on wheel with the weld on up-standing links facing away from wheel. See location of weld in figure 3-1. Install wheel on pinion shaft (43) by turning wheel clockwise until ratcheting occurs. Do not back off. Install thread stop (6) on pinion shaft spline so that the projection of the thread stop is 1/8 inch minimum to 1/4 inch maximum from roll pin. See figure 4-4. Install retainer ring (5).

j. Attach chain wheel cover (3) with three screws (1) and lock washers (2).

k. Invert the hoist on a work table. Drop loose end of the load chain (25) into the side of the load sheave (48) away from dead end screw (36) location. The first link of the chain should be flat in the load sheave pocket with the weld on the next link facing away from the load sheave. See location of weld in

**INSPECTION & MAINTENANCE CHECK LIST
HAND OPERATED OVERHEAD CHAIN HOIST**

TYPE OF HOIST _____ CAPACITY _____
 LOCATION _____ ORIGINAL INSTALLATION DATE _____
 MANUFACTURER _____ MANUFACTURER'S SERIAL NO. _____

| ITEM | FREQUENCY OF INSPECTION | | | POSSIBLE DEFICIENCIES | OK | ACTION REQUIRED |
|--|-------------------------|---------|----------|---|----|-----------------|
| | FREQUENT | | PERIODIC | | | |
| | DAILY | MONTHLY | 1-12 MO. | | | |
| Load Chain | * | * | * | Inadequate lubrication, excessive wear or stretch, cracked, damaged or twisted links, corrosion or foreign substance | | |
| Brake Mechanism | * | * | * | Slippage or Excessive Drift | | |
| Hooks | * | * | * | Excessive throat opening, bent or twisted more than 10 degrees, damaged hook latch, wear, chemical damage, worn hook bearing. Cracks (use dye penetrant, magnetic particle or other suitable detection method) | | |
| Hook Retainers | | | * | Worn or damaged nuts, pins, washers, collars used to secure hook in load block or housing | | |
| Brake Parts: Friction Discs | | | * | Excessive wear, glazing, oil contamination | | |
| Pawl, Ratchet Pawl - Spring | | | * | Wear, binding, worn bearing Breaks, corrosion or stretch | | |
| Pawl Stud Load Flange | | | * | Excessive wear, pawl retention Excessive wear, scoring | | |
| Sheave, Pinion Shaft, Hand Chain Wheel, Chain Attachments | | | * | Distortion, cracks, excessive wear, damaged threads | | |
| Gearing | | | * | Inadequate lubrication, cracks, distortion, worn or broken teeth | | |
| Bearings, Shafts | | | * | Inadequate lubrication, distortion, cracks, excessive wear | | |
| Housing, Hook Swivels | | | * | Cracks, distortion, loose bolts or nuts | | |
| Nuts, Bolts, Rivets | | | * | Looseness, stripped or damaged threads | | |
| Supporting Structure and Trolley (if used) | | | * | Damage or wear which restricts ability to support imposed loads | | |
| Warning Label | | | * | Missing, damaged or illegible | | |

NOTE: Refer to Maintenance and Inspection Sections of the Hoist Manual for further details.

FREQUENCY OF INSPECTION:

Frequent - Indicates items requiring inspection daily to monthly. Daily inspections may be performed by the operator if properly designated.

Periodic - Indicates items requiring inspection monthly to yearly. Inspections to be performed by or under the direction of a properly designated person. The exact period of inspection will depend on frequency and type of usage. Determination of this period will be based on the user's experience. It is recommended that the user begin with a monthly inspection and extend the periods to quarterly, semi-annually or annually based on his monthly experience.

FIGURE 4-7. RECOMMENDED INSPECTION & MAINTENANCE CHECK LIST.

NOTE: This inspection and maintenance check list is in accordance with our interpretation of the requirements of the safety standard for overhead hoists ANSI B30.16-73. It is, however, the ultimate responsibility of the employer/user to interpret and adhere to the applicable requirements of this safety standard.

SECTION V ILLUSTRATED PARTS LIST

5-1. GENERAL.

5-2. An exploded illustration of the Model CA Hoist follows. The number adjacent to each part is the index number. Keyed to this index number on the

following page is the part name and quantity required. When ordering parts for your hoist, please see page 1 of the current parts list.

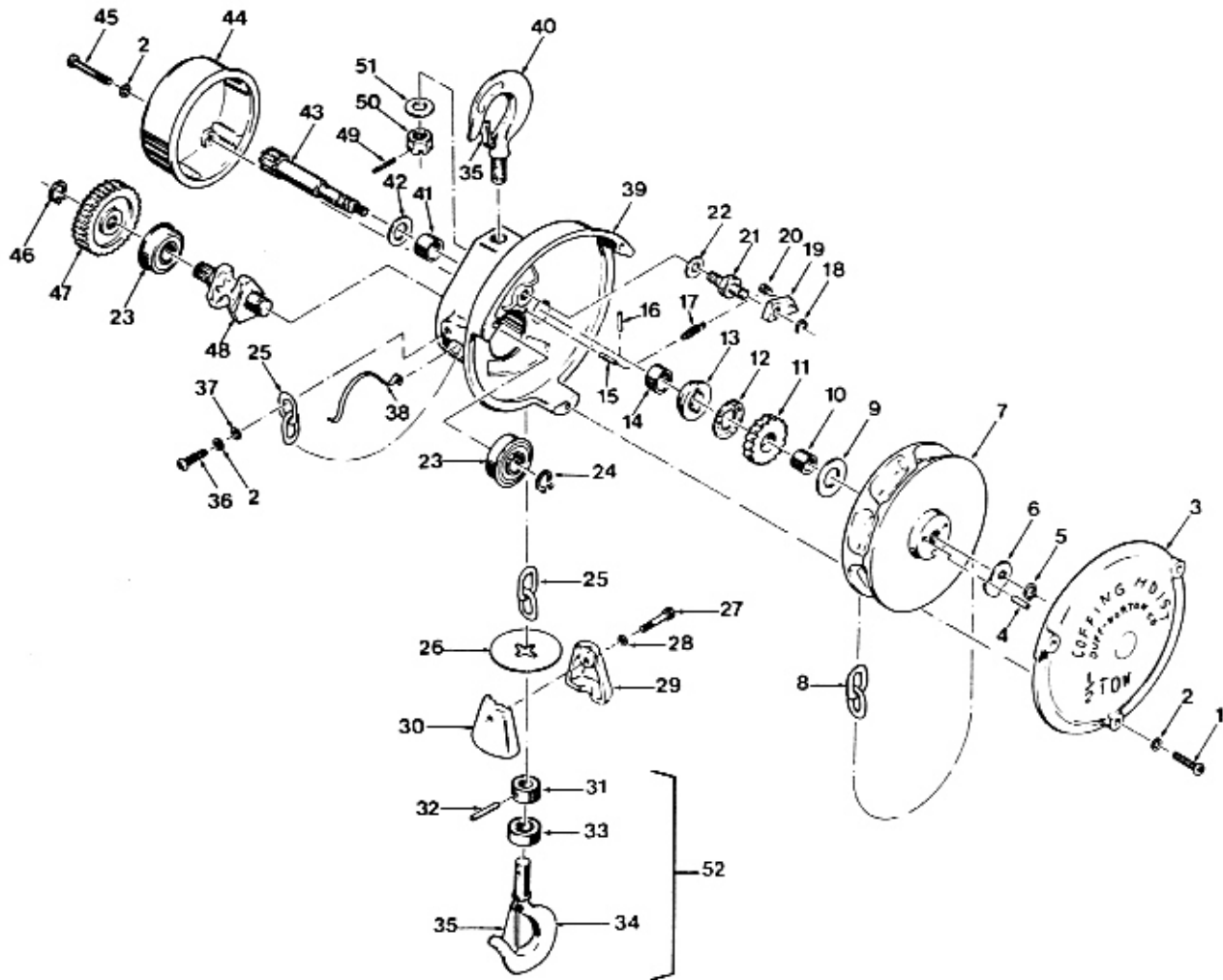

FIGURE 5-1. EXPLODED ILLUSTRATION OF MODEL CA HOIST

| INDEX NUMBER | PART NAME | QUANTITY REQUIRED |
|-----------------|---|----------------------|
| 1 | Screw | 3 |
| 2 | Lock Washers | 6 |
| 3 | Chain Wheel Cover | 1 |
| 4 | Roll Pin | 1 |
| 5 | Retaining Ring | 1 |
| 6 | Thread Stop | 1 |
| 7 | Hand Chain Wheel | 1 |
| 8 | Hand Chain | 14 ft. |
| 9 | Front Brake Disc | 1 |
| 10 | Bearing | 1 |
| 11 | Ratchet Assembly (Includes Index No. 10) | 1 |
| 12 | Rear Brake Disc | 1 |
| 13 | Load Flange | 1 |
| 14 | Bearing | 1 |
| 15 | Roll Pin | 1 |
| 16 | Pin Key | 1 |
| 17 | Reverse Pawl Spring | 1 |
| 18 | Retaining Ring | 1 |
| 19 | Pawl Assembly (Includes Index No. 20) | 1 |
| 20 | Spring Anchor Pin | 1 |
| 21 | Pawl Stud | 1 |
| 22 | Lock Washer | 1 |
| 23 | Bearing | 2 |
| 24 | Retaining Ring | 1 |
| 25 | Load Chain | 8'9" |
| 26 | Warning Label | 1 |
| 27 | Screw | 1 |
| 28 | Lock Washer | 1 |
| 29 | Swivel Frame | 1 |
| 30 | Swivel Frame | 1 |
| 31 | Hook Collar | 1 |
| 32 | Driv-Lok Pin | 1 |
| 33 | Bearing | 1 |
| 34 | Bottom Hook | 1 |
| 35 | Latch Kit | 2 |
| 36 | Dead End Screw | 1 |
| 37 | Washer | 1 |
| 38 | Chain Wear Strip | 1 |
| 39 | Housing | 1 |
| 40 | Top Hook | 1 |
| 41 | Bearing | 1 |
| 42 | Washer | 1 |
| 43 | Pinion Shaft | 1 |
| 44 | Gear Cover | 1 |
| 45 | Screw | 2 |
| 46 | Retaining Ring | 1 |
| 47 | Gear | 1 |
| 48 | Load Sheave | 1 |
| 49 | Roll Pin | 1 |
| 50 | Slotted Nut | 1 |
| 51 | Thrust Washer | 1 |
| 52 | Bottom Hook Assembly (Includes Index Nos. 31-35) | 1 |

DUFF-NORTON HAS ALL YOU NEED TO HANDLE A VARIETY OF TOUGH INDUSTRIAL, MAINTENANCE AND CONSTRUCTION LIFTING JOBS.

Coffing® is America's first name in quality, industrial hoisting equipment. Nowhere else can you find such a broad range of hoists with such consistent high-quality construction and durability. A detailed

product catalog is available from your local Coffing hoist distributor, Duff-Norton District Sales Manager, or by writing directly to Duff-Norton Company. Ask for Catalog 200, it includes:

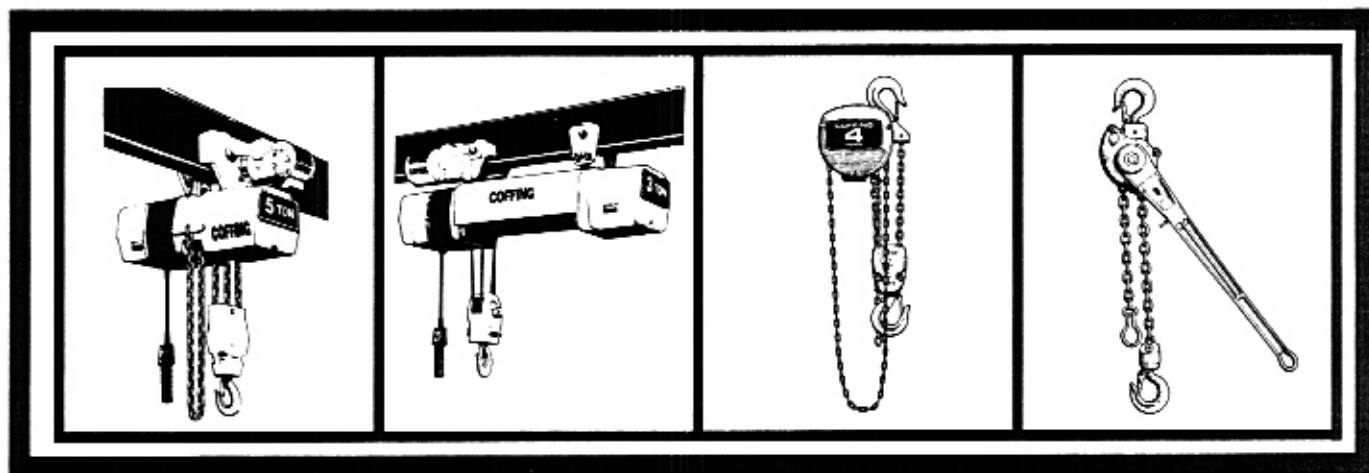

Coffing® Electric Chain Hoists

Load ratings from ¼ to 5 tons. More standard features than any comparable hoist. Two-speed options available; 47 models to choose.

Coffing® Electric Wire Rope Hoists.

Low headroom units with load ratings from ½ to 3 tons. Choice of rigid hook or lug suspensions, plus plain, geared or motorized trolleys. Single or two speed options and variety of standard lifts. 35 models.

Coffing® Hand Chain Hoists.

Designed for light weight and long life with minimum maintenance. Optional capacity limiter available in some models. 99 models in rated loads from ½ to 25 tons.

Coffing® Lever Hoists.

A variety of mechanisms and rated loads from ¼ to 15 tons; in 36 models for both conventional and special purpose applications.

WARNING: The equipment shown in this manual is intended for industrial use only and should not be used to lift, support, or otherwise transport people, or to suspend unattended loads over people.

AVAILABLE FROM YOUR LOCAL DUFF NORTON COFFING®/DUFF LYNX® HOIST DISTRIBUTOR:



P.O. Box 7010
Charlotte, NC 28241-7010

Customer Service (800) 477-5003
Parts Service (800) 477-5004
FAX (704) 588-8466