

# Duff-Norton

## ADJUSTMENT INSTRUCTIONS

WITH PARTS LISTS

PUBLICATION PART NO. CL-698-1

**COFFING®  
HOISTS**

### ALUMINUM HAND CHAIN HOISTS

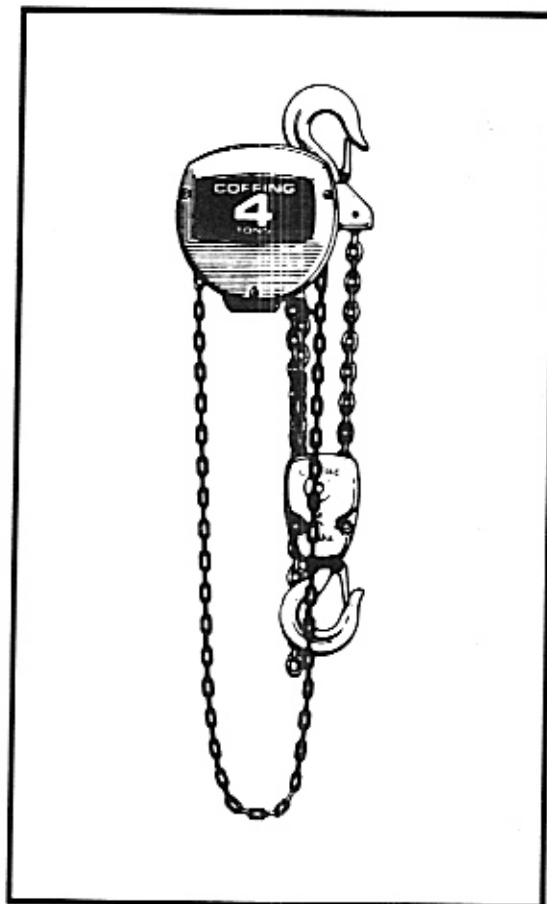

**CAPACITY  
LIMITERS  
FOR  
CB SERIES**

#### IMPORTANT — CAUTION

This manual contains important information for the correct installation, operation and maintenance of the equipment described herein. All persons involved in such installation, operation and maintenance should be thoroughly familiar with the contents. To safeguard against the possibility of personal injury or property damage, follow the recommendations and instructions of this manual and keep it for further reference.

#### WARNING

The equipment shown in this manual is intended for industrial use only and should not be used to lift, support, or otherwise transport people, or to suspend unattended loads over people.

**BEATON**

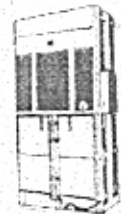

OVERHEAD EQUIPMENT  
HOISTS

ERGONOMICS

HYDRAULIC  
BALERS

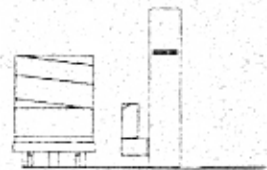
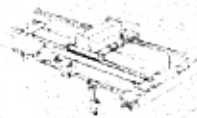

AIR CURTAINS  
BALERS/COMPACTORS  
BELOW HOOK  
BENCHES/CARTS/TOOLS  
BRIDGE CRANES  
CABINETS  
CASTERS/WHEELS  
CONTAINERS/WHEELS  
CONVEYORS  
DOCK EQUIPMENT  
ENGINEERED SYSTEMS  
FLOOR MATTING  
OVERHEAD DOORS  
DRUM HANDLING  
FLAMMABLE CABINETS  
FLOW RACK  
GANTRY CRANES  
GUARD RAIL  
HAND TRUCKS  
HIGH SPEED ROLL UP DOORS  
HOISTS  
INDUSTRIAL BATTERIES  
INDUSTRIAL VACUUMS  
INPLANT OFFICES  
INSTALLATIONS  
JIB CRANES  
LAYOUTS/DESIGNS  
LIFTERS  
LIFT TABLES  
LOCKERS  
MACHINE MOVERS  
MESSAGE TRANSFER  
MEZZANINES  
MODULAR DRAWER CABINETS  
MOBILE AISLE STORAGE  
OFFICE FURNITURE  
OVERHEAD LIFTING EQUIPMENT  
PALLETS  
PALLET TRUCKS  
PERSONNEL LIFTS  
SAFETY LADDERS  
SCALES  
SELF DUMPING HOPPERS  
SERVICE/SERVICE CONTRACTS  
STACKER CRANES  
STORAGE PRODUCTS  
STRETCH WRAP MACHINES  
SHIPPING SUPPLIES  
TABLES  
TOILET PARTITIONS  
AND MANY MORE...

CONVEYOR

BRIDGE CRANES

WRAPPERS



SLINGS

RACKING/SHELVES

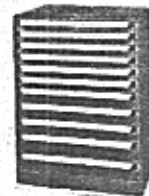

**Beaton Industrial, Inc.**

6083 Trenton Road  
Utica, NY 13502

Ph. 1-800-724-4052 (N.Y. Only)

Ph. 1-315-797-9346

Fax 1-315-797-9321

e-mail:

beaton@deamscape.com

Web:

www.BeatonIndustrial.com

SHOP EQUIPMENT



HAND TRUCKS

www.BeatonIndustrial.com

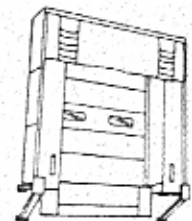

DOCKS, DOORS, SEALS



PULLERS



MEZZANINES

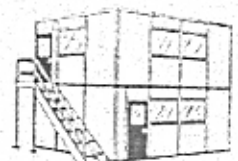

INPLANT OFFICES

HOIST AND CRANE REPAIR CENTER  
INSTALLATIONS, PARTS, SERVICE  
DESIGN/LAYOUT/ FABRICATIONS,  
APPLICATION STUDIES  
CRANE & HOIST INSPECTIONS



CASTERS

*"Specializing In Materials Handling"*

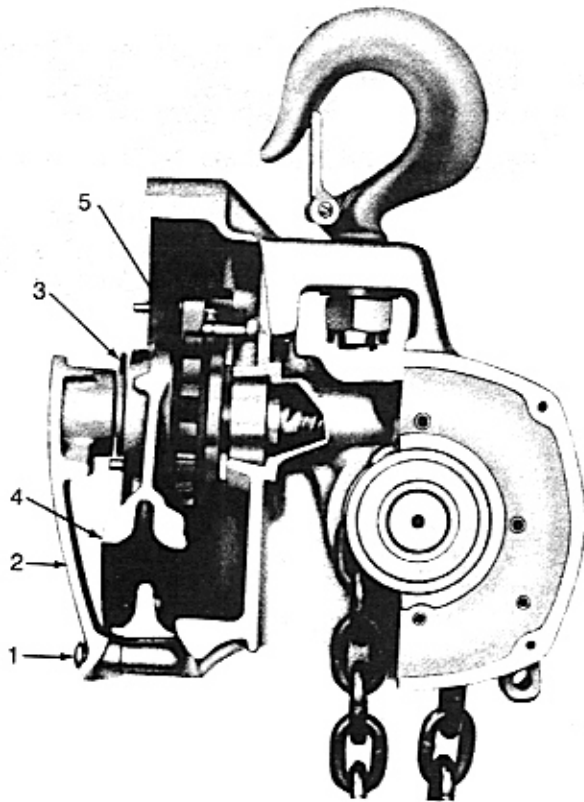

FIGURE 1

### REPLACING HAND CHAIN WHEEL WITH PREADJUSTED CAPACITY LIMITER

1. Remove three screws holding cover in place.
2. Remove Cover.
3. Remove Thread Stop from Spline on Pinion.
4. Unthread and remove hand chain wheel with hand chain in position.
5. Make sure brake disc is in position next to ratchet.

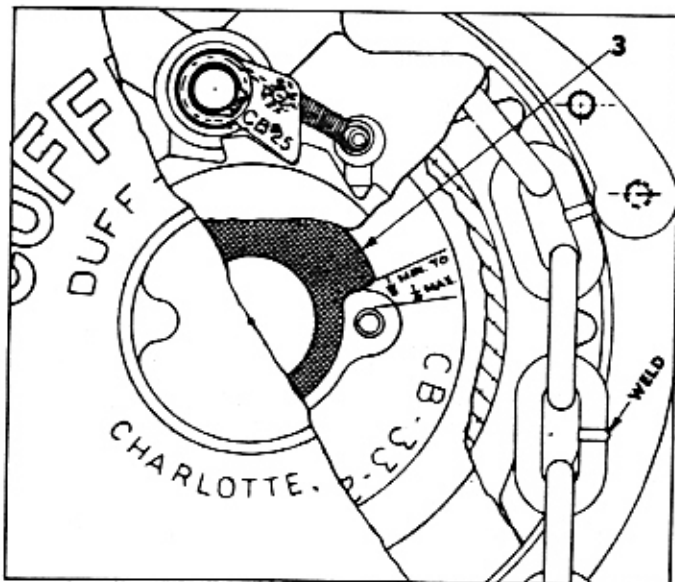
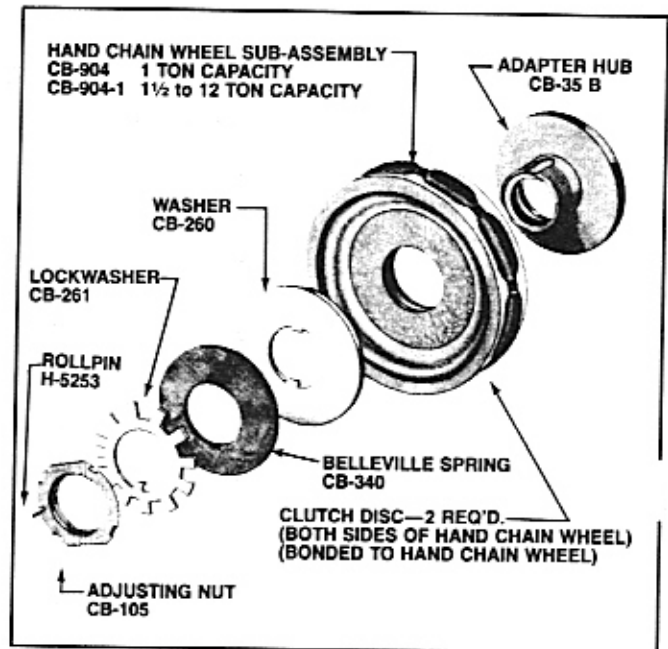

FIGURE 2

6. Thread "Capacity Limiter" assembly in place of standard hand chain wheel with hand chain in position with welds on chain facing out (See Fig. 2). Tighten it hand tight on brake disc.
7. Replace thread stop (3) on spline as shown in Fig.
8. Replace cover (2) in position.
9. Replace cover screws (1) with washers and tighten.



### REPAIR PARTS—CAPACITY LIMITER

| Part No. | Part Description                                      | Number Required |
|----------|---|-----------------|
| CB-35 B  | Adapter Hub   | 1               |
| CB-105   | Adjusting Nut   | 1               |
| CB-260   | Plain Washer  | 1               |
| CB-261   | Lock Washer   | 1               |
| CB-340   | Spring Washer   | 1               |
| CB-904   | Handwheel Sub Assembly<br>(Includes 2 Friction Discs) | 1               |
| CB-904-1 | Handwheel Sub Assembly<br>(Includes 2 Friction Discs) | 1               |
| H-5253   | Rollpin   | 1               |

## RECALIBRATION PROCEDURE

Whether it is purchased with the hoist or as a separate kit your "Capacity Limiter" has been factory calibrated to slip predetermined overload (approximately 150% of rated ..) If excessive slippage is noted when operating hoist at full rated capacity the "Capacity Limiter" can be recalibrated using the following procedure.

1. To check for excessive slippage remove handchain wheel cover and apply a pencil mark to the washer and to an adjacent point on the handchain wheel (See Figure 4).

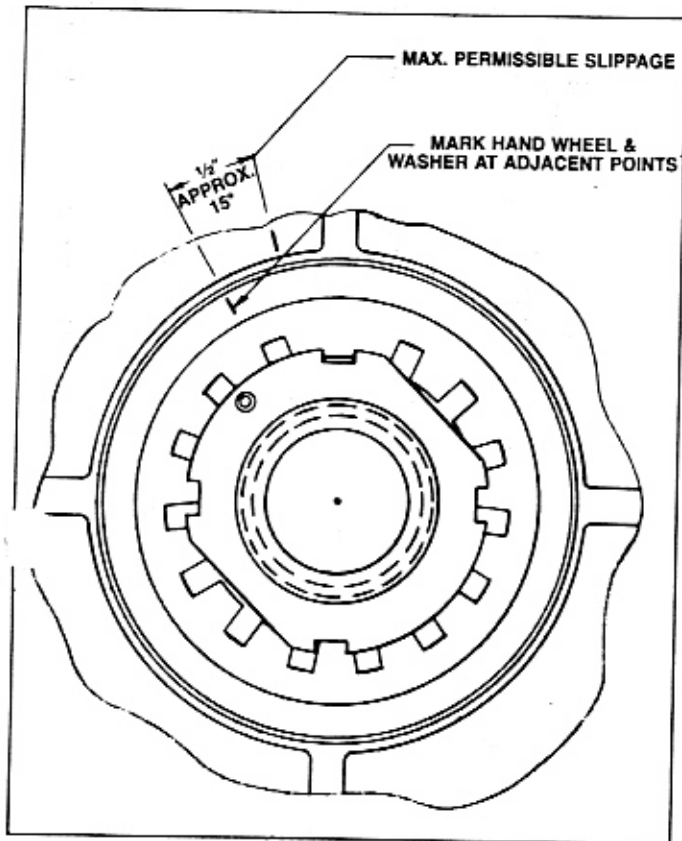

FIGURE 4

2. Replace thread stop and hand chain wheel cover and set hoist up to lift a load equal to its rated capacity.
3. After hooking to load apply 10 pulls of 2 to 3 ft. each to the hand chain in the hoisting direction. These pulls should be made with an even, steady motion. Avoid jerking effort on handchain.
4. After lowering the load remove the handchain wheel cover and observe the relationship of the pencil marks that were applied in Step 1.
5. If the displacement of the two marks exceeds 15° or 1/2" (See Figure 4) the slip torque should be increased by tightening the Adjusting Nut (Part No. CB-105) in clock-

wise direction so that the notch in the lock nut lines up with the next succeeding tang on the lock washer. Bend the tang into the adjusting nut notch to secure the nut.

6. Repeat marking procedure as described in Step 1 above. Reassemble thread stop, hand chain wheel cover and retest unit as described above.
7. If slippage is still excessive repeat the above steps until slippage falls within recommended limit.

**CAUTION**—Do not disassemble the "Capacity Limiter" unit. If disassembled it is recommended that the unit be returned to the factory for inspection and recalibration. Please give hoist serial number (stamped on hoist housing) and hoist capacity when returning to factory.

# DUFF-NORTON HAS ALL YOU NEED TO HANDLE A VARIETY OF TOUGH INDUSTRIAL MAINTENANCE AND CONSTRUCTION LIFTING JOBS.

Coffing® is America's first name in quality, industrial hoisting equipment. Nowhere else can you find such a broad range of hoists with such consistent high-quality construction and durability. A detailed

product catalog is available from your local Coffing hoist distributor, Duff-Norton District Sales Manager, or by writing directly to Duff-Norton Company. Ask for **Catalog 200**, it includes:

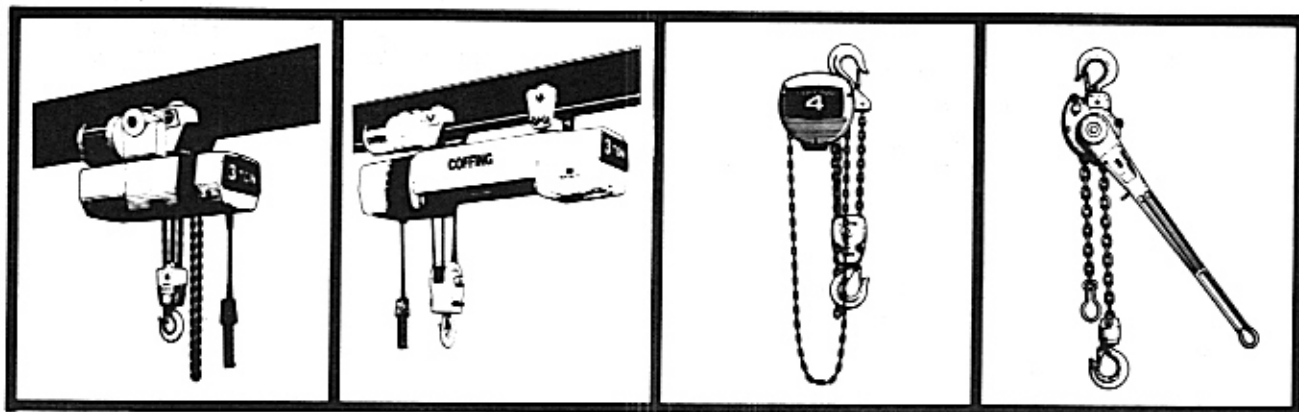

#### Coffing® Electric Chain Hoists

Load ratings from ¼ to 5 tons. More standard features than any comparable hoist. Two-speed options available; 47 models to choose.

#### Coffing® Electric Wire Rope Hoists.

Low headroom units with load ratings from ½ to 3 tons. Choice of rigid hook or lug suspensions, plus plain, geared or motorized trolleys. Single or two speed options and variety of standard lifts. 35 models.

#### Coffing® Hand Chain Hoists.

Designed for light weight and long life with minimum maintenance. Optional capacity limiter available in some models. 99 models in rated loads from ½ to 25 tons.

#### Coffing® Lever Hoists.

A variety of mechanisms and rated loads from ¼ to 15 tons; in 36 models for both conventional and special purpose applications.

**WARNING:** The equipment shown in this manual is intended for industrial use only and should not be used to lift, support, or otherwise transport people, or to suspend unattended loads over people.

**AVAILABLE FROM YOUR LOCAL  
DUFF NORTON COFFING®/DUFF  
LYNX® HOIST DISTRIBUTOR:**

**Duff-Norton**

P.O. Box 7010  
Charlotte, NC 28241-7010

Customer Service (704) 588-2720  
Parts Service (704) 588-2323  
FAX (704) 588-1994  
TELEX 575188

Duff-Norton Manufactures:  
Duff-Norton® Actuators • Mechanical Jacks • Rotary Unions • Coffing® Hoists  
Duff Lynx® Hoists and Pullers